

3. Additional information

Replacing the battery in your Smart Tag Tracker

The Smart Tag Tracker comes with a CR2032 battery pre-installed. These can last up to 12 months. When the battery needs replacing, use a small Philips head screwdriver (not supplied) to loosen the screw, then detach the battery compartment cover.

Remove the old battery and safely dispose. Replace with a new CR2032 battery ensuring the positive side faces outwards.

Put the battery cover back on and carefully tighten the screw.

WARNING: DO NOT OVERTIGHTEN THE SCREW. There will be a beep after a few seconds and using your iPhone nearby, check your item is available again in your Find My app.

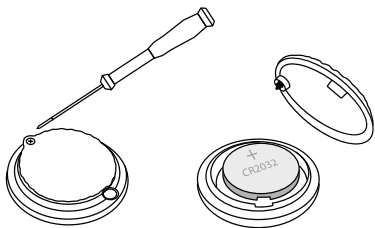

Troubleshooting

- Check battery and replace if necessary.
- If you have an issue after connection, please try setting up the Smart Tag Tracker again:

Remove the item from your Find My app.

Restart your Smart Tag Tracker by removing the battery and waiting for 2-3 seconds before reinstalling the battery.

Add your Smart Tag Tracker as a new item in your Find My app.

- If you are still having issues or the Smart Tag Tracker doesn't appear available to connect in your Find My app during the initial setup, it may be in Power Saving Mode. If this happens, remove and reinstall the battery 5 times. Each time you reinstall the battery, you should hear a beeping sound. On the fifth time, a musical tone will indicate the Smart Tag Tracker is now ready to be set up once again.



4. Product Support

For the most up-to-date assistance, please scan this QR code for product support.

Stay Connected



⚠ SAFETY AND WARNING INFORMATION

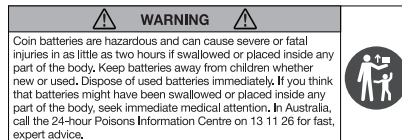

Recommendations:

1. KEEP BATTERIES OUT OF REACH OF CHILDREN.
2. Swallowing may lead to serious injury in as little as 2 hours or death, due to chemical burns and potential perforation of soft tissue.
3. Keep in original packaging until ready to use.
4. Do not use if the component is not secure.
5. Risk of fire and burns.
6. Do not recharge, disassemble, heat or incinerate.
7. Battery may explode or leak if heated, disassembled, shorted, recharged, exposed to fire or inserted incorrectly.
8. Dispose of used batteries promptly and safely in compliance with local regulations. Tape the terminal to prevent sparking that may create a fire hazard.
9. Operating temperature -20°C + 70 °C



walkntalk



Smart Tag Tracker

with keyring and luggage tag

PWT-SMART

walkntalk

Quick Start Guide

What's included:



Product Overview:

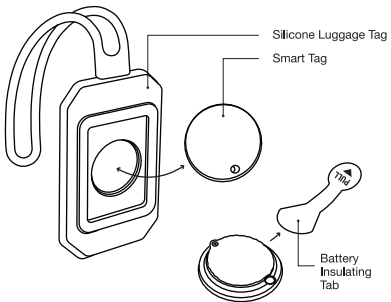

1. Setting up your Smart Tag Tracker



Pull the battery insulating tab from the back of the Smart Tag Tracker. With your iPhone (or iPad) nearby, open the Find My app. Ensure you have Bluetooth turned on.

After removing the battery insulating tab, you will have about 10 minutes to connect to the Smart Tag Tracker, otherwise it will go into Power Saving Mode. If this happens, please refer to Troubleshooting section.

In the Find My app go to Items.

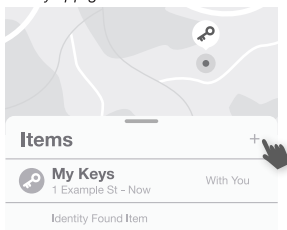

Tap + then "Add Other Item" (on some devices it might have "Other Supported Item"). Once your Smart Tag Tracker is located tap "Connect".

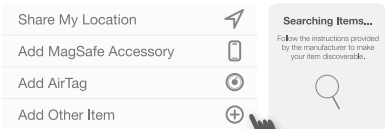

Choose a name from the list or you can customise with your own and Emoji icon. When finished, tap "Continue".

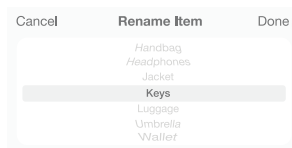

Attach the Smart Tag Tracker to your keyring, luggage tag or any item you want to track.

You can also configure advanced options including notifications for when you leave your item behind and sharing the item location with another iPhone user.

2. Finding your lost items

Locate your Smart Tag Tracker on a map

Simply open the Find My app on your iPhone and look in **Items** for the Smart Tag Tracker you setup earlier. Tap on the item name to show more details including the last known location on a map.

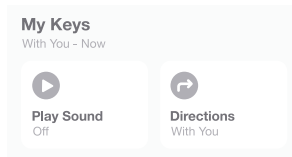

Play a sound to find your Smart Tag Tracker nearby

If the Smart Tag Tracker is nearby (within 10-20m), you can use the Find My app to trigger it to ring by tapping "Play Sound".

What if you can't find your Smart Tag Tracker?

If your item is lost and not in range, enable **Notify When Found** and turn on **Lost Mode** in the Find My app. When enabled, you can enter a phone number or email address so you can be contacted when the item is found.

When Lost Mode is turned on and your Smart Tag Tracker comes near a compatible iPhone:

Your iPhone will be notified with the Smart Tag Tracker's location on the Find My app.

The other person's iPhone will receive a notification, with the contact details you provided when you activated Lost Mode.

